

Data Sheet



Article number: 58SE80S0600G

Description: Cylinder ISO1552 SE 80x600-S-G Ø80-600
port 3/8 - with buffer adjustment

Measures

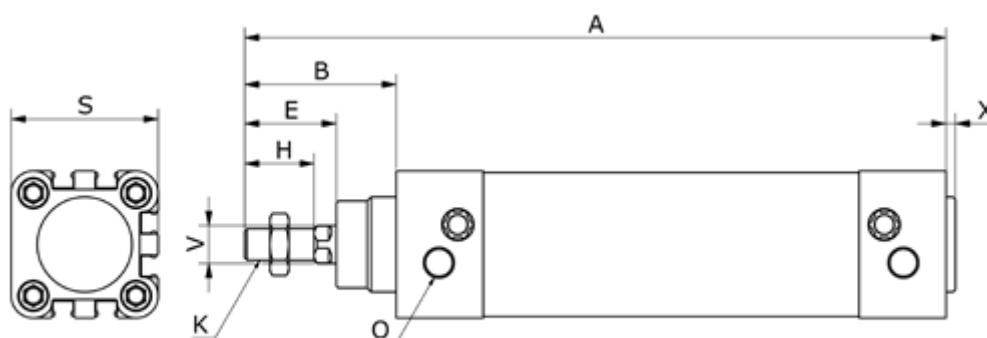

A = 814

B = 86

Bore diameter = 80

E = 53

HS = 40

K = M20x1,50

O = 3/8"

S = 93.0

Stroke = 600

V = 25

X = 4